

Cutting Kit

SLC
Developed by
The Light Group

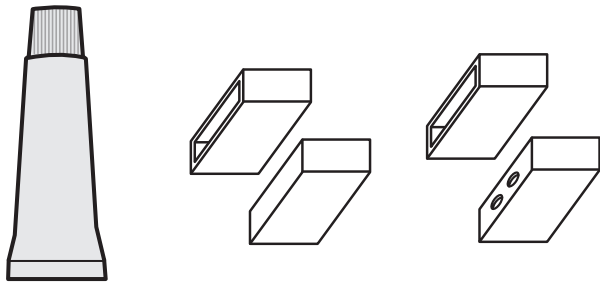

Art.no	Article	PCB	X
S90176	Cutting kit IP67 8mm PCB	8	10
S90177	Cutting kit IP67 10mm PCB	10	12
S90178	Cutting kit IP67 12mm PCB	12	14

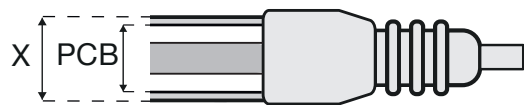

1

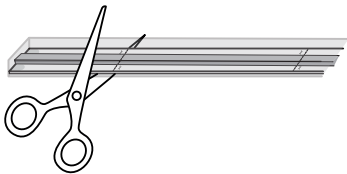

2

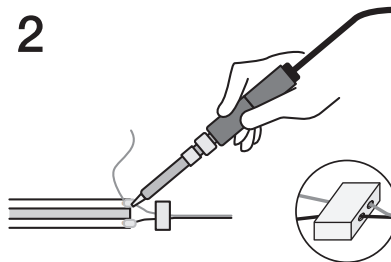

3

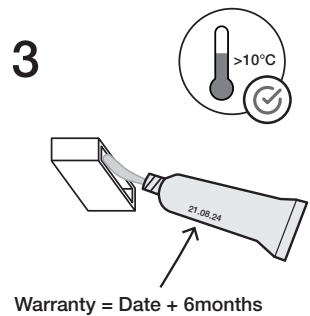

Warranty = Date + 6months

4



5



@ 25°C = 1 hr

@ 10°C = 3-4 hr



NO: Må installeres av godkjent installator
EN: Only to be installed by an authorized electrician
DE: Nur von einer autorisierten Elektrofachkraft installierenlassen
FI: Asenna vain valtuutettu sähköasentaja
FR: Seulement pour être installé par un électricien autorisé
IS: Aðeins skal setja upp af viðurkenndum rafvirkri
ES: Solo para ser instalado por un electricista autorizado.
IT: Solo per essere installato da un elettricista autorizzato



NO: Slå av strømmen før montering
EN: Power off before installing
DE: Schalten Sie vor der Installation die Stromversorgung aus
FI: Katkaise virta ennen asennusta
FR: Couper le courant avant d'installer
IS: Slökktu á orku áður en þú setur upp
ES: Apague la alimentación antes de instalar
IT: Spegnerne l'alimentazione prima di installare



Management, Operation
and Maintenance