

JUST LIGHT.



JUST LIGHT.

JUST LIGHT GmbH
Olakenweg 36 · D-59457 Werl
☎ +49(0)2922 9721 9290
✉ Kundenservice@neuhaus-group.de
www.just-light.info

901660 - TOLAGO

DE

DE Dieses Produkt enthält eine Lichtquelle der Energieeffizienzklasse <E>.

GB This product contains a light source of energy efficiency class <E>.

FR Ce produit comprend une source de lumière de classe d'efficacité énergétique <E>

ES Este producto contiene una fuente de luz de la clase de eficiencia energética <E>.

HR Ovaj proizvod sadrži izvor svjetlosti energetskog razreda <E>.

HU Ez a termék <E> energiahatékonysági osztályba tartozó fényforrást tartalmaz.

IT Questo prodotto contiene una sorgente luminosa della classe di efficienza energetica <E>.

NL Dit product bevat een lichtbron van energie-efficiëntieklasse <E>.

GB

FR

ES

HR

HU

IT

NL

LED

22 W / 2 W

2.800 lm



24 W

1.600 lm

t

25.000 h

T_K

3.000 K - 6.500 K / RGB



15.000 x



< 0,5 s



901660

220-240V / 50/60Hz~

LED

1x LED-Board 45V DC/22 W

1x LED-Borad 45V DC/2 W

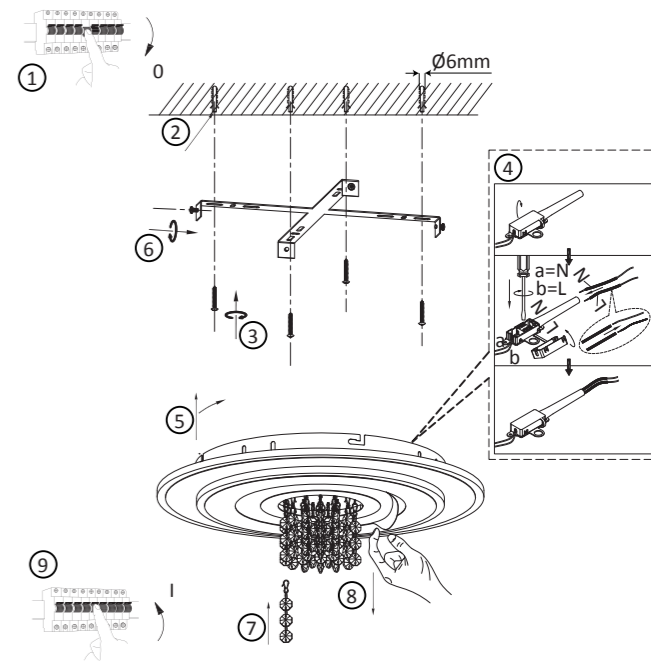

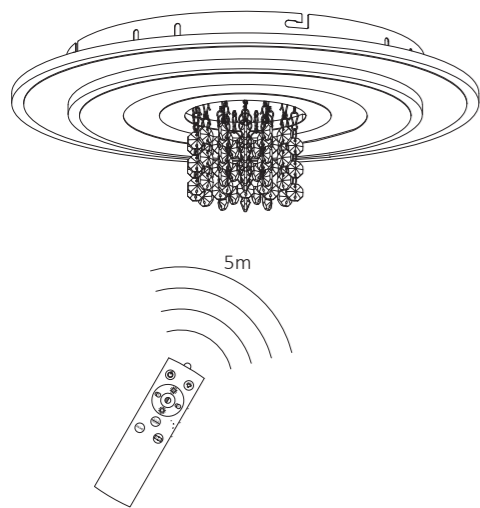

E0040149

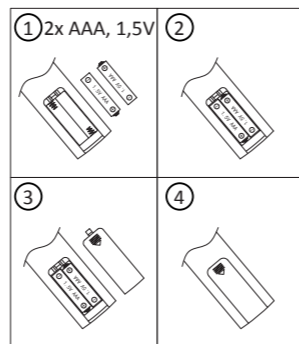
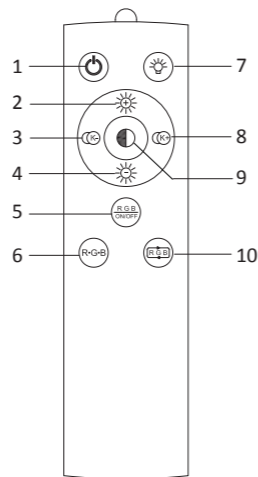

- | | |
|--|-----------------------------|
| 1. Aus/An | 1. On/Off |
| 2. Helligkeit erhöhen | 2. Increases the brightness |
| 3. Farbtemperatur wechsel / Color temperature change | |

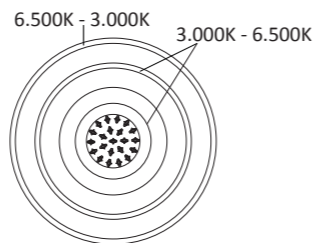

- | | |
|--------------------------|-----------------------------|
| 4. Helligkeit reduzieren | 4. Decreases the brightness |
| 5. RGB Aus/An | 5. RGB On/Off |
| 6. Farbauswahl | 6. Color selection |

7. Nachtlcht / Night light

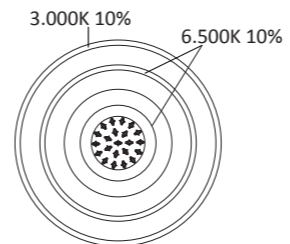

8. Farbtemperatur wechsel / Color temperature change

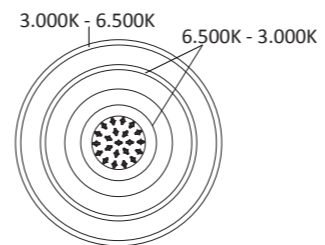

9. 3.000K / 4.000K / 6.500K

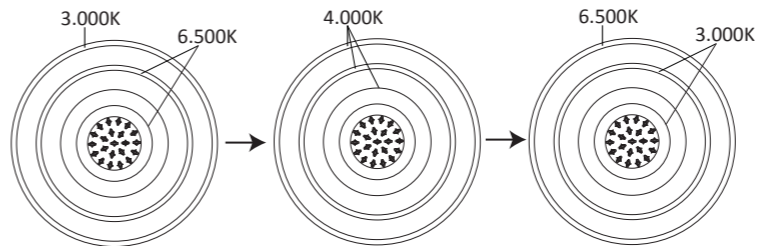

- | | |
|---------------------|-------------------|
| 10. • Farbdurchlauf | 10. • Color cycle |
| • Farbwechsel | • Color change |